

MP-9

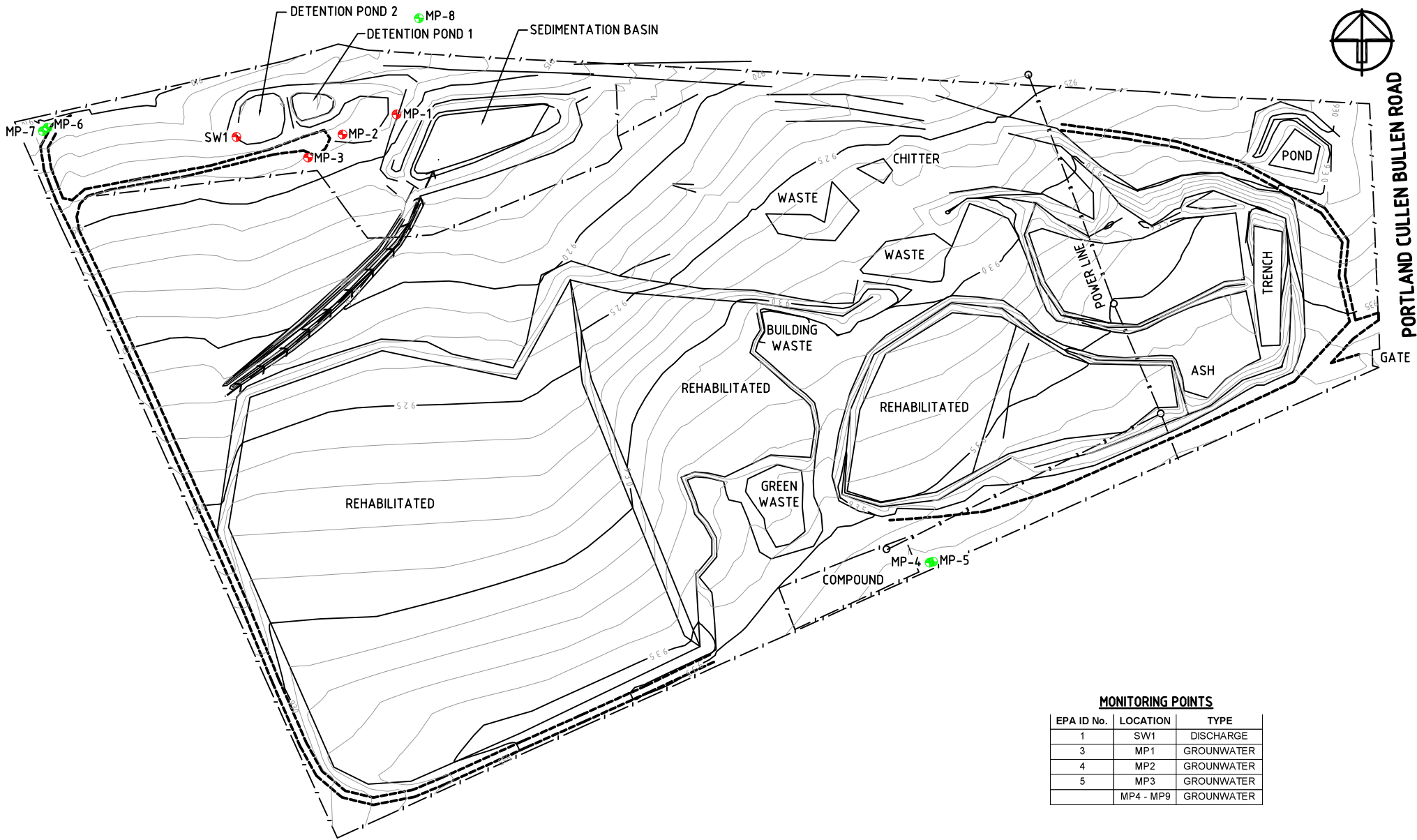

PORTLAND CULLEN BULLEN ROAD

MONITORING POINTS

EPA ID No.	LOCATION	TYPE
1	SW1	DISCHARGE
3	MP1	GROUNWATER
4	MP2	GROUNWATER
5	MP3	GROUNWATER
	MP4 - MP9	GROUNWATER

LEGEND:

- + EPA MONITORING POINT
- + ADDITIONAL MONITORING POINT

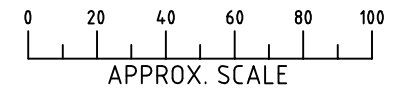

GEOLYSE
ORANGE
1st FLOOR
28-31 SALE STREET
P.O. BOX 1983
ORANGE, NSW 2800
Ph: (02) 6382 1055
Fax: (02) 6361 8178
orange@geolyse.com
www.geolyse.com

No	DATE	DEVELOPER CHECK	PI CHECK	DETAILS
A	15/09/08	-	-	ISSUED TO CLIENT
B	11/05/11	LRP	AGB	ISSUED TO CLIENT
C	01/11/12	MDH	KBF	ISSUED TO CLIENT

PROJECT
PORTLAND WASTE DISPOSAL DEPOT
FILE REFERENCE: 0:\Projects\202334_01B_EV01.dwg

APPROVAL AUTHORITY
ENVIRONMENTAL PROTECTION AUTHORITY
EPL: 10936

CLIENT
 LITHGOW CITY COUNCIL
180 MORT STREET,
LITHGOW NSW 2790

DRAWING
ENVIRONMENTAL MONITORING POINTS
PROJECT NUMBER: 202334 DRAWING NUMBER: 01C_EV01 REV: C
SOURCE: CRAVEN, ELLISTON & HAYES (LITHGOW) PTY.LTD.
CONSULTING LAND, ENGINEERING AND MINING SURVEYORS